

July  
A.  
S. A. Graham  
at 3:30 P.M.  
#5603.

8 CHAINS PER INCH

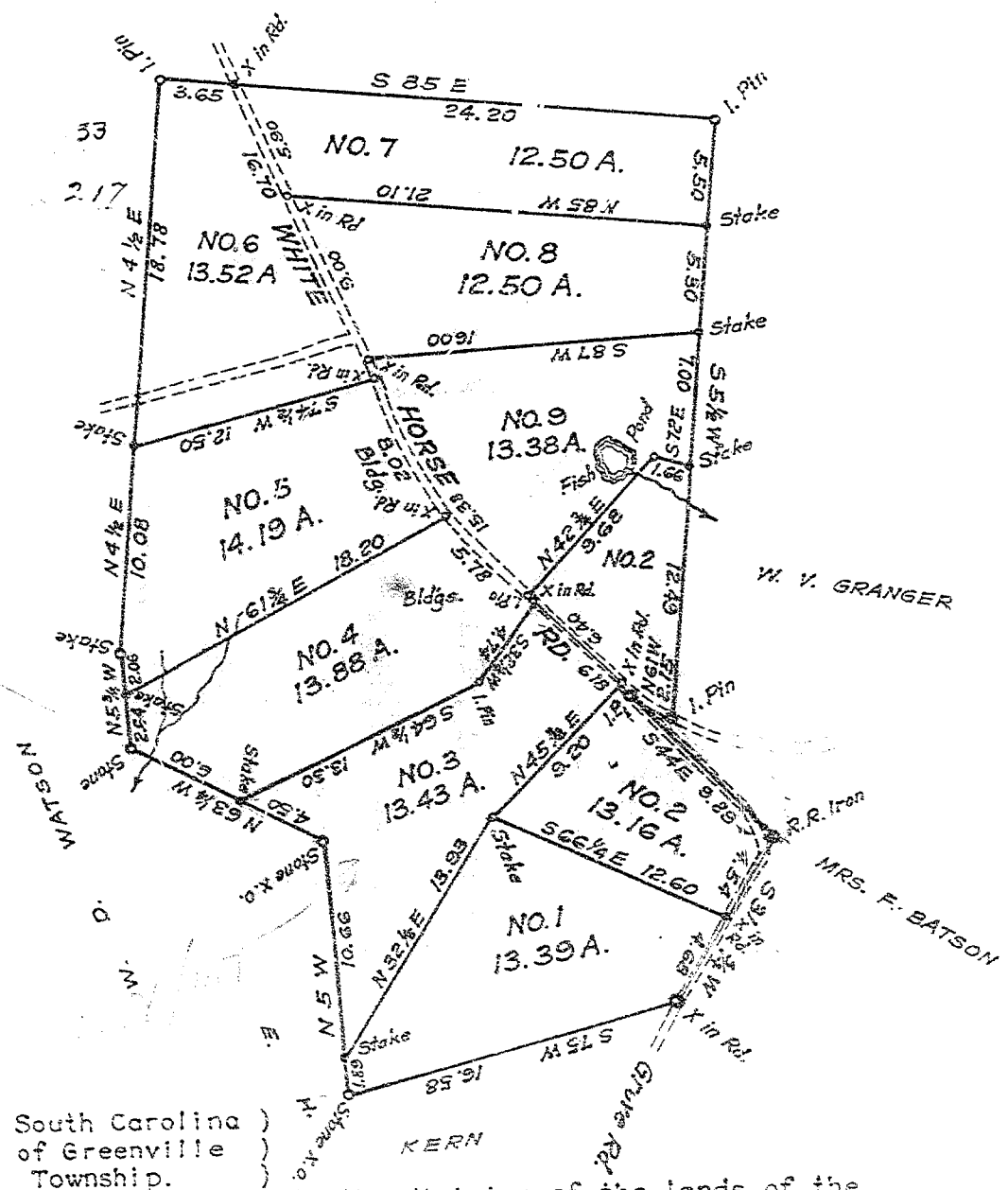

State of South Carolina )  
County of Greenville )  
Gantt Township.

This plat represents the division of the lands of the  
W.M. MYERS estate. The said division being into Nine (9) tracts.  
Area (more or less,) Courses and Corners as shown above.

Dec. 12, A. D. 1932.

B. F. Wigington.  
Surveyor.